

Flow Direction →

PT.NO.	Part Name	Material					
		SGI	WCB	CF8	CF8M	CF3	CF3M
1	BODY	SGI	WCB	CF8	CF8M	CF3	CF3M
2	DISC	-	WCB	CF8	CF8M	CF3	CF3M
3	SPRING	SS-316					
4	'O' RING DISC	NITRILE / EPDM / PTFE/ REQUIRED					
5	BUTTON	SS-316					
6	EYE BOLT	EN-8					
7	SPRING RETAINER	SS-316					

NOTES :

- 1) Dimension 'C' as per API 6D, CL 300 (Short Pattern) except size 125 : others only indicative.
- 2) # Weights are approx. and shall vary depending on flanges standard and material specification.
- 3) WCB body and disc are duly blackened powder coated.
- 4) Internal Dia of pipe should be at least 3mm more than 'D'.
- 5) All dimensions are in mm.

CODE	500/7	WCB	CF8	CF8M	316	304
MATERIAL	IS1865	A216	A351	A351	A276	A276
SECN.	SGI	WCB	CF8	CF8M	316	304

TEST PRESSURES, bar								
RATING	150	300	PN6	PN10	PN16	PN25	PN40	
HYD	SHELL	30	77	9	15	24	37.5	60
	SEAT	22	57	6.6	11	17.6	27.5	44

DESIGN STD. API 6D / TESTING STD. API 6D / API 598														
SIZE	C 1)	φ A										φ B	φ D	# WT. Kg. (Apx.)
		ASME	B16.5	BS EN 1092					BS-10					
		CL150	CL300	PN6	PN10	PN16	PN25	PN40	T-D	T-E				
50	19	104.5	111	98	109	109	109	109	98.5	98.5	30	42	1.3	
65	19	124	130.5	118	129	129	129	129	111	111	38	51	1.8	
80	19	136.5	149	134	144	144	144	144	130	130	52	66	2.2	
100	19	174.5	179	154	164	164	170	170	162	162	72	88	3	
125	22	197	216	184	194	194	196	196	193.5	193.5	90	108	4.5	

DRAWN : VINOD	PRODUCT : SPRING LOADED WAFER CHECK VALVE SIZE : DN-50 TO DN-125	REV - 00
DATE : 09.06.17		DATE - 09.06.17
CHECKED : KINAGI		DRAWING NO. - PW50-125
APPD. : RB		SCALE - NTS
DATE : 09.06.17		-

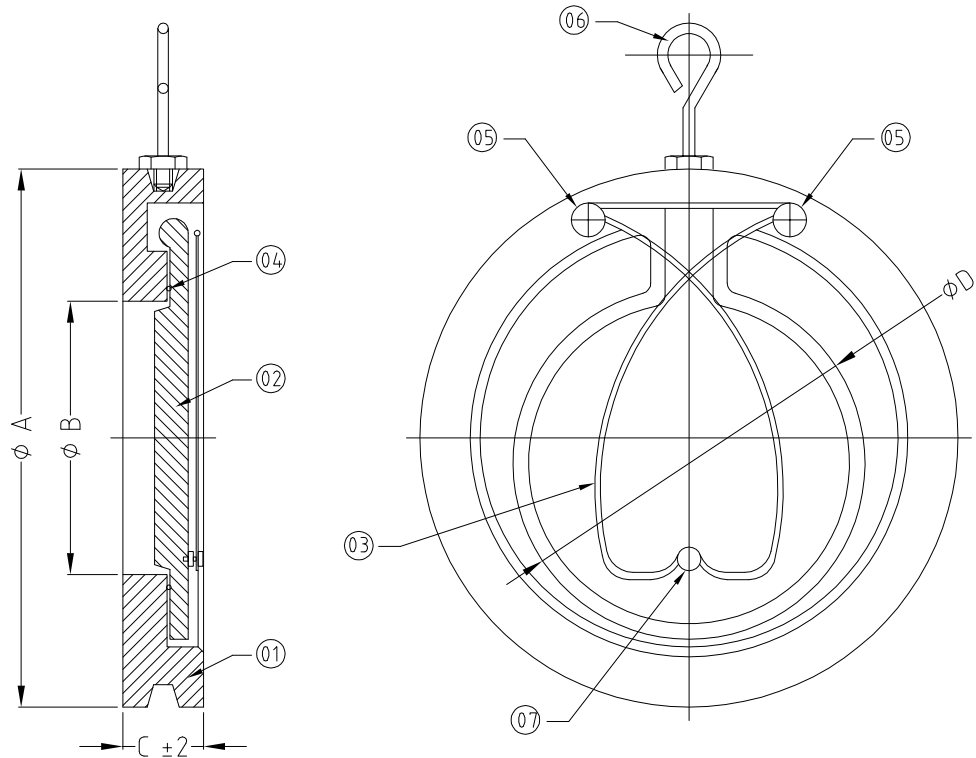

Flow Direction →

PT.NO.	Part Name	Material					
		SGI	WCB	CF8	CF8M	CF3	CF3M
1	BODY	SGI	WCB	CF8	CF8M	CF3	CF3M
2	DISC	-	WCB	CF8	CF8M	CF3	CF3M
3	SPRING	SS-316					
4	'O' RING DISC	NITRILE / EPDM/PTFE/ REQUIRED					
5	BUTTON	SS-316					
6	EYE BOLT	EN-8					
7	SPRING RETAINER	SS-316					

NOTES :

- 1) Dimension 'C' as per API 6D, CL 300 (Short Pattern) except size 125 : others only indicative.
- 2) # Weights are approx. and shall vary depending on flanges standard and material specification.
- 3) WCB body and disc are duly blackened powder coated.
- 4) Internal Dia of pipe should be at least 3mm more than 'D'.
- 5) All dimensions are in mm.

CODE	500/7	WCB	CF8	CF8M	316	304
MATERIAL	IS:1865	A216	A351	A351	A276	A276
SECN.	SGI	WCB	CF8	CF8M	316	304

TEST PRESSURES, bar								
RATING	150	300	PN6	PN10	PN16	PN25	PN40	
HYD	SHELL	30	77	9	15	24	37.5	60
	SEAT	22	57	6.6	11	17.6	27.5	44

DESIGN STD. API 6D / TESTING STD. API 6D / API 598														
SIZE	C 1)	φ A										φ B	φ D	# WT. Kg. (Apx.)
		ASME	B16.5	BS EN 1092					BS-10					
		CL150	CL300	PN6	PN10	PN16	PN25	PN40	T-D	T-E				
150	22	222.5	250.5	209	220	220	226	226	219	216.0	115	136	6.0	
200	29	279.5	308.0	264	275	275	286	293	276	273	158	180	14.0	
250	38	340.0	362	319	330	331	343	355	336	336	196	218	19.0	
300	51	409.5	422.5	375	380	386	403	387	387	384	242	264	27	

DRAWN : VINOD	PRODUCT : SPRING LOADED WAFER CHECK VALVE SIZE : DN-150 TO DN-300	REV - 00
DATE : 09.06.17		DATE - 09.06.17
CHECKED : KINAGI		DRAWING NO. - PW150-300
APPD. : RB		SCALE - NTS
DATE : 09.06.17		-